

## CSL0103

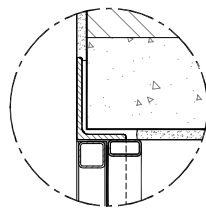

Section at Head

2 Position Service Hatch

Type 1 Slam Lock

Adjustable Lock Keep (fail-safe)

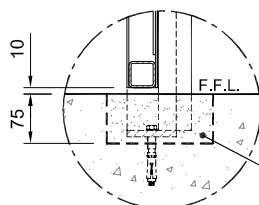

Threshold Detail

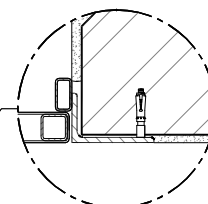
Chase in floor  
by othersSecure Corridor Side  
(Door Opens Outwards)Gasket Free Spyhole with  
Swivel Cover.

Frame Detail

2100mm Structural Opening Height

910mm Structural Opening Width



TESTED VIEWER

**Specification**

- Door panel constructed from 40mm wide rolled hollow steel sections with 3mm thick steel door skins.
- Mineral wool insulation to all internal voids.
- 125mm x 75mm x 8mm rolled steel angle frame.
- 50mm x 25mm RHS rebate.
- Frame fixed into the structural opening with concealed 12mm dia sleeve anchors.
- Door panel mounted within the door frame and hung on a substantial continuous hinge.
- Reinforcing plates to inside of door panel on cell side up to the height of the lock.
- Home Office Type 1 slam action lock with adjustable keep.
- Single hand operation 2 position service hatch.
- Gasket free circular spyhole with swivel cover.

**Finish**

- One coat factory applied high build zinc phosphate primer to all mild steel surfaces.

**Options**

- 0.8mm thick rigidised stainless steel bright annealed skin to cell side of door panel. (Pattern ref: 12LG)
- Vertical louvred vision panel.
- Full view 3 position service hatch.
- Stainless Steel rebates.
- Monitored hatch for Life Signs Monitoring.

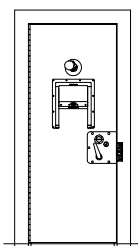

CSL0103